

# DuPont™ **Tyvek®** INSTALLATION GUIDELINES

## WALL: Tyvek® Supro, Tyvek® Supro Plus, Tyvek® Solid, Tyvek® Housewrap, Tyvek® Soft

### Key Benefits

- ✓ Technical specifications surpass BS4016 requirements
- ✓ Membranes provide temporary weather protection during construction
- ✓ Materials are easy to apply, cut and form around details
- ✓ UKAS approved



- Starting 300 mm from a corner, wrap the **Tyvek®** membrane completely around the external face of the sheathing board. Make sure that the membrane overlaps the lowest timber member by 100 mm. Normal practice is to unroll the membrane horizontally, but vertical application is also acceptable.



- Fix the membrane with galvanised nails or stainless steel staples as follows:
  - Horizontal centres = max 600 mm
  - Vertical centres = max 300 mmExtend the **Tyvek®** membrane to cover window and door openings and staple or nail around the openings at 150 mm centres. Any vertical laps formed in the membrane should be a minimum of 150 mm. Horizontal laps between sheets and any laps onto cavity trays or flashings should be a minimum of 100 mm. Sealing the laps with **Tyvek® Tape** is optional.

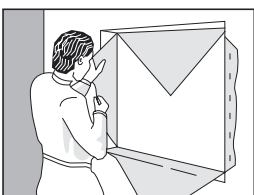

- Once the **Tyvek®** membrane installation is complete cut an 'X' from corner to corner at window and door openings, fold inwards and staple/nail to reveals. Make good to the corners with **Tyvek® Tape**. If windows and doors are already in place turn the membrane up against the frame to prevent water ingress. Stud positions for wall ties can be easily marked by using an indelible marker pen.

### Damage

Any damage in the **Tyvek®** membrane can be easily repaired using **Tyvek® Tape**.

### Accessories

DuPont™  
**Tyvek®**  
Tape

DuPont™  
**Tyvek®**  
Butyl Tape

DuPont de Nemours (Luxembourg) S.à.r.l.  
L-2984 Luxembourg  
Tel: (+352) 3666 5885  
Fax: (+352) 3666 5021  
E-mail: [tyvek.construction@lux.dupont.com](mailto:tyvek.construction@lux.dupont.com)

For more information, visit:

[www.tyvek.co.uk](http://www.tyvek.co.uk)



**Tyvek®**

Recommendations as to methods, use of materials and construction details are based on the experience and current knowledge of DuPont and are given in good faith as a general guide to designers, contractors and manufacturers. This information is not intended to substitute for any testings you may need to conduct to determine for yourself the suitability of our products for your particular purposes. This information may be subject to revision as new knowledge and experience becomes available since we cannot anticipate all variations in actual end-use conditions. DuPont makes no warranties and assumes no liability in connection with any use of this information. Nothing in this publication is to be considered as a licence to operate under a recommendation to infringe any patent right.